

PROJECT UPDATE

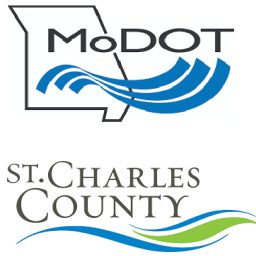

CONSTRUCTION UPDATES

As we move into summer, crews are working on the second half of the new bridges at Zumbahl and Cave Springs. You'll be seeing the walls of the bridges being built up and the bridge deck being poured over the next several months. Both bridges are expected to be operating in their new configuration by the end of the year.

In addition, crews are working on the second half of the arch structure that will eventually carry Veterans Memorial Parkway under Cave Springs.



SAFETY SPOTLIGHT

As summer travel heats up, the Missouri Department of Transportation is urging drivers to be cautious and patient and use good judgment when traveling. Impaired driving, distracted driving, excessive speeds, and not wearing seat belts are just a few of the concerns that can accompany the increased traffic.

Along with increased summer traffic, there's also increased work zones. On any day in Missouri there are more than 1,000 work zones for road and bridge construction or maintenance work. That includes work on Interstate 70 at Cave Springs, Zumbahl and I-70 at Route 94 as part of the I-70 Cave Springs to Fairgrounds Design-Build Project.

Drivers can stay informed of work zone locations and traffic delays on MoDOT's Traveler Information Map at traveler.modot.org, also available as a free mobile app for Apple and Android devices.



NAVIGATING THE WORKZONE

Drivers are continuing to navigate the temporary change to Veterans Memorial Parkway (VMP) at Cave Springs. VMP traffic will only be able to go eastbound between Cave Springs Boulevard and Mexico Road through the end of the year. No westbound traffic is allowed. In addition, temporary slip ramps are being used between the interstate and VMP.

Signed detours are up to help drivers navigate the area.

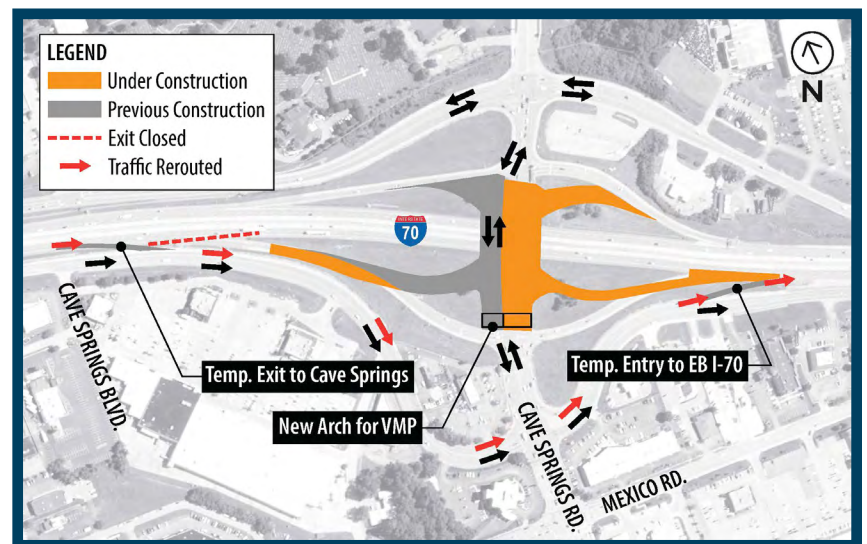

Once construction is completed, this section of VMP will be returned to two-way traffic, including westbound VMP across Cave Springs which was not allowed prior to this project.